

Office to let

Swan Office & Technology Park - Henley

Voluntari, 15-23 Bucuresti Nord road



Building information

Building status	Existing
Year of construction	2011
Parking ratio	1 / 61 sq m
Total building area	7 257 sq m

Commercial terms

Office space*	after login *
Parking	after login *
Service charge*	after login *
Minimum lease term	after login *
Availability	after login *

* Asking terms for m²/month

Location

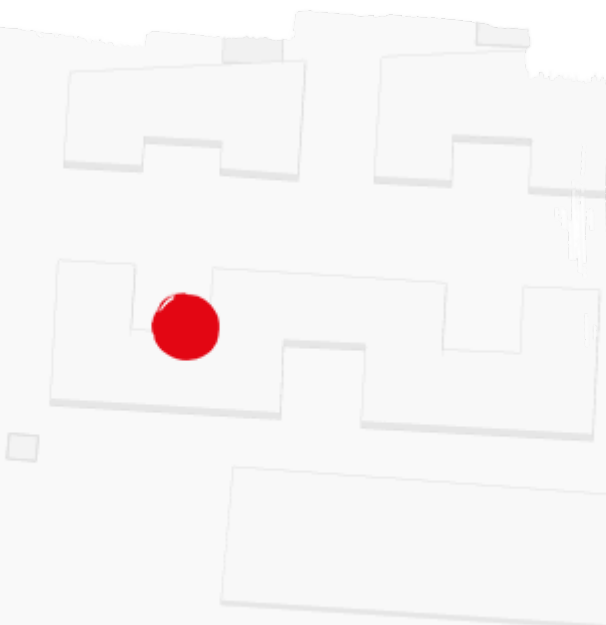

Available space











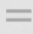

588 sq m

Available office space

217 sq m

Minimum office space

Standard fit-Out

-  Air conditioning
-  Raised floor
-  Suspended ceiling
-  Telephone cabling
-  Computer cabling
-  Power cabling
-  Smoke detectors
-  Carpeting
-  Reception
-  Security
-  Fibre optics
-  Switchboard
-  Openable windows

Typical floor plan

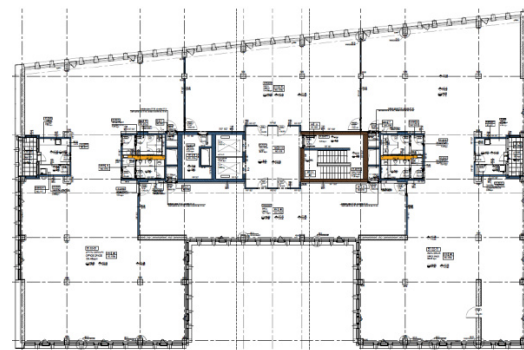

Available space

Floor	Vacant space	Availability
2	please contact us *	please contact us *
2	please contact us *	please contact us *
Total	after login *	

Public transport

Bus: 416, 450, 459

Contact

 +40 21 302 3400

More information